

**RECOMMENDED
CLAMPING BOLT
TORQUE RANGE**

- 14" = 150 to 200 ft. lb.
- 16" = 150 to 200 ft. lb.
- 18" = 175 to 225 ft. lb.
- 20" = 200 to 250 ft. lb.
- 24" = 225 to 275 ft. lb.
- 30" = 250 to 300 ft. lb.
- 36" = 250 to 300 ft. lb.
- 42" = 250 to 300 ft. lb.
- 48" = 250 to 300 ft. lb.

For best results use low end of recommended torque range on DR41 and DR51 PVC Pipe.

1300 Installation Instructions / 14" - 48" PVC*

Refer to the Ford® website (www.fordmeterbox.com) for additional and most recent installation instructions and product information.

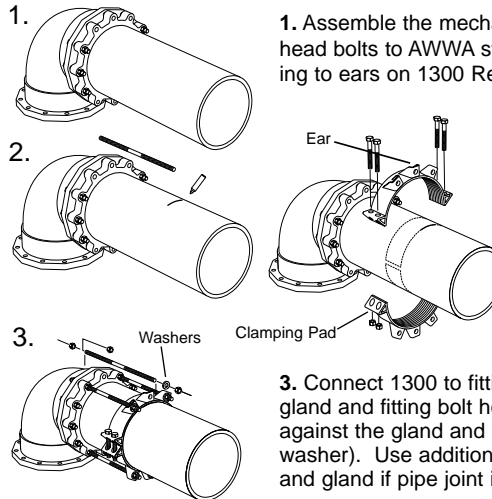

1. Assemble the mechanical joint, installing gasket, gland and Tee-head bolts to AWWA standards. Leave out Tee-head bolts corresponding to ears on 1300 Restrainer.

2. Use one of the rods (provided) as a guide, and mark a line on the pipe to position 1300 restrainer. Leave sufficient threads on the rod ends to fully engage nuts. Tighten clamping bolts on each side evenly, to recommended torque (see recommended clamping bolt torque range table), ensuring the gaps between pads on both sides remain even. A torque wrench is required to ensure proper torque. The clamping pads will not touch.

3. Connect 1300 to fitting by inserting all rods through restrainer ear, gland and fitting bolt holes. Install one nut behind fitting bell, one against the gland and one behind / outside the restrainer ears (against washer). Use additional nuts (not included) on inside of retainer ears and gland if pipe joint is expected to contract.

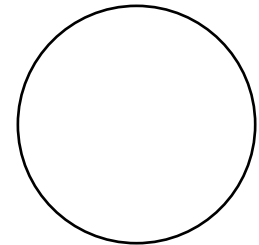

* Contact Ford Meter Box for alternate pipeline materials, water pressure ratings and clamping bolt torque requirements.



The Ford Meter Box Company, Inc., 775 Manchester Avenue, P.O. Box 443, Wabash, Indiana, USA 46992-0443
Telephone: 260-563-3171 FAX: 800-826-3487 Overseas FAX: 260-563-0167 www.fordmeterbox.com

FORM # 91785-99

03/21

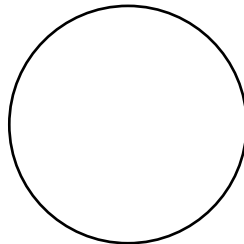

1390 Installation Instructions / 14" - 48" PVC*

Refer to the Ford® website (www.fordmeterbox.com) for additional and most recent installation instructions and product information.

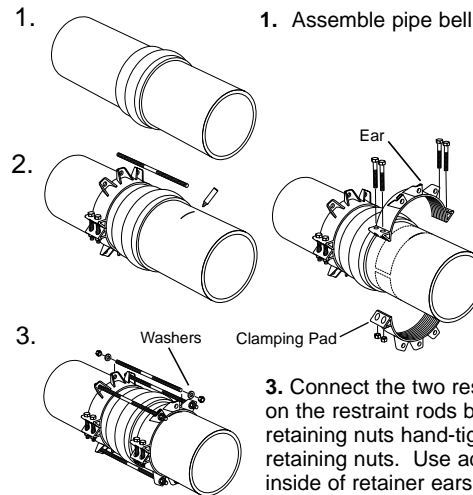

1. Assemble pipe bell according to pipe manufacturer's instructions.

2. Assemble one restrainer on spigot end of pipe, and one directly behind pipe bell. Use one of the rods (provided) as a guide, and mark a line on the pipe to position serrated restrainers. Leave sufficient threads on the rod ends to fully engage nuts. Tighten clamping bolts on each side evenly, to recommended torque (see recommended clamping bolt torque range table), ensuring the gaps between pads on both sides remain even. A torque wrench is required to ensure proper torque. The clamping pads will not touch.

3. Connect the two restrainers using all rods provided. Place a washer on the restraint rods behind / outside the restrainer ears. Tighten all retaining nuts hand-tight, then one revolution. Do not over-tighten retaining nuts. Use additional nuts and washers (not included) on inside of retainer ears if pipe joint is expected to contract.

**RECOMMENDED
CLAMPING BOLT
TORQUE RANGE**

- 14" = 150 to 200 ft. lb.
- 16" = 150 to 200 ft. lb.
- 18" = 175 to 225 ft. lb.
- 20" = 200 to 250 ft. lb.
- 24" = 225 to 275 ft. lb.
- 30" = 250 to 300 ft. lb.
- 36" = 250 to 300 ft. lb.
- 42" = 250 to 300 ft. lb.
- 48" = 250 to 300 ft. lb.

For best results use low end of recommended torque range on DR41 and DR51 PVC Pipe.

* Contact Ford Meter Box for alternate pipeline materials, water pressure ratings and clamping bolt torque requirements.



The Ford Meter Box Company, Inc., 775 Manchester Avenue, P.O. Box 443, Wabash, Indiana, USA 46992-0443
Telephone: 260-563-3171 FAX: 800-826-3487 Overseas FAX: 260-563-0167 www.fordmeterbox.com

FORM # 91785-99

03/21