

If supplied, the plastic Auto-Tork screw stop rings must be removed from 4", 6" and 8" sizes for use on steel-sized pipe and SDR 35 Sewer Pipe

**INSTALLATION INSTRUCTIONS
SERIES 1500 AND 1500-OS
CIRCLE LOCK
JOINT RESTRAINT FOR
3"-36" C900 PVC, CIOD HDPE*
4"-18" C909 PVC
3"-12" IPS (STEEL SIZE) PVC
AND HDPE*
4"-8" SDR35 SEWER PIPE**

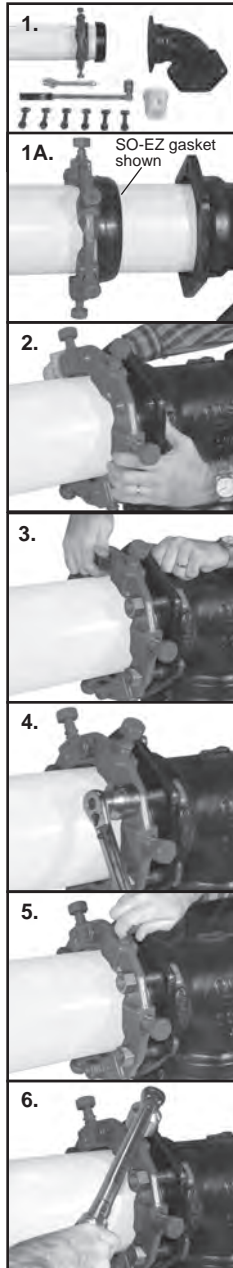

Refer to the Ford® website (www.fordmeterbox.com) for additional and most recent installation instructions and product information.

- Clean the socket and plain end. Lubricate socket, gasket and plain end with an approved pipe lubricant meeting AWWA C111. Place the gland on the plain end with the lip extension toward the plain end, followed by the lubricated gasket with the narrow edge of the gasket toward the plain end.
1A. Note: A transition gasket must be used for 3" - 12" IPS PVC and HDPE* pipe, or use the Uni-Flange SO-EZ MJ gasket for 3"-12" C900, C909 or IPS PVC pipe. The SO-EZ gasket can be snapped onto the gland compression lip instead of first pressing it into the socket as stated in step number 2.
- Insert the pipe into the socket and press the gasket firmly and evenly into the gasket recess. Keep the joint straight during assembly. In cold conditions, it is best to warm the gasket approximately to room temperature to facilitate assembly.
- Push the gland toward the socket and center it around the pipe with the gland lip against the gasket. Insert Tee-head bolts and hand tighten nuts. Set deflection after joint assembly but before tightening Tee-head bolts. (Maximum allowable deflection is 5° except for 2° on 4"-8" C909, 3" C900 and 3" IPS PVC.)
- Tighten the Tee-head bolt nuts to the torque recommended in the table below. Tighten in an alternating manner, (6 o'clock, 12 o'clock, 9 o'clock, 3 o'clock) maintaining the same gap between the gland and the MJ socket face at all points around the socket. Repeat the process until all bolts are within the recommended torque range. Use of a torque wrench is strongly recommended and required to ensure proper torque.

RECOMMENDED TEE-HEAD BOLT TORQUE (FT-LB)			
NOMINAL PIPE SIZE	PIPE TYPE		
	C900, IPS (ASTM D2241) AND HDPE	C909	
3"	45 - 60	Not Applicable	
4" - 24"	75 - 90	50	
30" & 36"	100 - 120	Not Applicable	

- After correct assembly of the mechanical joint, bring all restraint segments in contact with the pipe surface by turning the Auto-Tork actuating screws in a clockwise direction.
Note: The 4", 6" and 8" sizes may have a removable, supplemental stop-ring installed on each Auto-Tork actuating screw at the factory. On steel-sized pipe and SDR 35 sewer pipe, the supplemental stop ring must be removed.
 - Continue tightening the Auto-Tork screws in an alternating manner until the heads twist off.
Note: To re-use or re-install the UFR1500 after the Auto-Tork break-off heads have been removed; tighten the 5/8" hex head of the actuating screw to 65 ft-lb. Although it is not a requirement, it is always good practice to **recheck the Tee-head bolt torque prior to backfilling and/or applying water pressure.**
- * When installing on HDPE pipe, follow the insert recommendations and precautions stated on Ford® website installation instruction form #91929-99.

4" THROUGH 12" MECHANICAL JOINT RETAINER GLAND

<FMD>
APPROVED
C900 4"-12"
C909 4"-8"

	UFR1500-4-OS	ASTM F1674
	UFR1500-6-OS	
	UFR1500-8-OS	
	UFR1500-10	
	UFR1500-12	

FORD The Ford Meter Box Company, Inc.
P.O. Box 443, Wabash, IN 46992-0443
260-563-3171 / FAX: 800-826-3487
www.fordmeterbox.com

Ti SALES

36 Hudson Rd Sudbury MA 01776 800-225-4616 www.tisales.com

FORM # 99003-99

If supplied, the plastic Auto-Tork screw stop rings must be removed from 4", 6" and 8" sizes for use on steel-sized pipe and SDR 35 Sewer Pipe

**INSTALLATION INSTRUCTIONS
SERIES 1500 AND 1500-OS
CIRCLE LOCK
JOINT RESTRAINT FOR
3"-36" C900 PVC, CIOD HDPE*
4"-18" C909 PVC
3"-12" IPS (STEEL SIZE) PVC
AND HDPE*
4"-8" SDR35 SEWER PIPE**

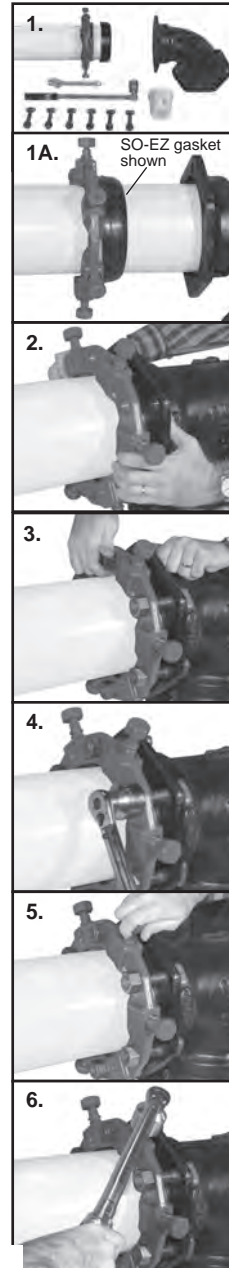

Refer to the Ford® website (www.fordmeterbox.com) for additional and most recent installation instructions and product information.

- Clean the socket and plain end. Lubricate socket, gasket and plain end with an approved pipe lubricant meeting AWWA C111. Place the gland on the plain end with the lip extension toward the plain end, followed by the lubricated gasket with the narrow edge of the gasket toward the plain end.
1A. Note: A transition gasket must be used for 3" - 12" IPS PVC and HDPE* pipe, or use the Uni-Flange SO-EZ MJ gasket for 3"-12" C900, C909 or IPS PVC pipe. The SO-EZ gasket can be snapped onto the gland compression lip instead of first pressing it into the socket as stated in step number 2.
- Insert the pipe into the socket and press the gasket firmly and evenly into the gasket recess. Keep the joint straight during assembly. In cold conditions, it is best to warm the gasket approximately to room temperature to facilitate assembly.
- Push the gland toward the socket and center it around the pipe with the gland lip against the gasket. Insert Tee-head bolts and hand tighten nuts. Set deflection after joint assembly but before tightening Tee-head bolts. (Maximum allowable deflection is 5° except for 2° on 4"-8" C909, 3" C900 and 3" IPS PVC.)
- Tighten the Tee-head bolt nuts to the torque recommended in the table below. Tighten in an alternating manner, (6 o'clock, 12 o'clock, 9 o'clock, 3 o'clock) maintaining the same gap between the gland and the MJ socket face at all points around the socket. Repeat the process until all bolts are within the recommended torque range. Use of a torque wrench is strongly recommended and required to ensure proper torque.

RECOMMENDED TEE-HEAD BOLT TORQUE (FT-LB)			
NOMINAL PIPE SIZE	PIPE TYPE		
	C900, IPS (ASTM D2241) AND HDPE	C909	
3"	45 - 60	Not Applicable	
4" - 24"	75 - 90	50	
30" & 36"	100 - 120	Not Applicable	

- After correct assembly of the mechanical joint, bring all restraint segments in contact with the pipe surface by turning the Auto-Tork actuating screws in a clockwise direction.
Note: The 4", 6" and 8" sizes may have a removable, supplemental stop-ring installed on each Auto-Tork actuating screw at the factory. On steel-sized pipe and SDR 35 sewer pipe, the supplemental stop ring must be removed.
 - Continue tightening the Auto-Tork screws in an alternating manner until the heads twist off.
Note: To re-use or re-install the UFR1500 after the Auto-Tork break-off heads have been removed; tighten the 5/8" hex head of the actuating screw to 65 ft-lb. Although it is not a requirement, it is always good practice to **recheck the Tee-head bolt torque prior to backfilling and/or applying water pressure.**
- * When installing on HDPE pipe, follow the insert recommendations and precautions stated on Ford® website installation instruction form #91929-99.

4" THROUGH 12" MECHANICAL JOINT RETAINER GLAND

<FMD>
APPROVED
C900 4"-12"
C909 4"-8"

	UFR1500-4-OS	ASTM F1674
	UFR1500-6-OS	
	UFR1500-8-OS	
	UFR1500-10	
	UFR1500-12	

FORD The Ford Meter Box Company, Inc.
P.O. Box 443, Wabash, IN 46992-0443
260-563-3171 / FAX: 800-826-3487
www.fordmeterbox.com

FORM # 99003-99

12/20